



# Smart Music Control Application

JVC KENWOOD Corporation

2016

Smart Music Control Application

User Guide



# CONTENTS

---

<b>CONTENTS</b>	<b>2</b>	<b>Media Player Shortcut</b>	<b>7</b>
<b>GETTING STARTED</b>	<b>1</b>	<b>JSMC Remote Control Mode</b>	<b>8</b>
Installing Smart Music Control App		Entering into Remote Control Mode	
Preparing the Music Player		<b>Source Control Main Screen</b>	<b>8</b>
<b>MEDIA PLAYER</b>	<b>1</b>	Status Indicator	
Media Player Screen		Source Name Screen	
Category Selection Screens		Source Info Bar	
Current List Screen		Media Information Panel	
Mood Blender Screen		Play Time Bar	
Making a Playlist		<b>Car Receiver Settings</b>	<b>10</b>
Equalizer Screen		Entering Car Receiver Settings	
Mood Playlist		EQ Settings	
Song Background Analysis		Fader/Balance Settings	
<b>HOME LAUNCHER</b>	<b>4</b>	HPF/LPF Settings	
Accessing the Home Launcher		Color Settings	
The Home Launcher Screen		<b>OPERATION FEATURES</b>	<b>13</b>
<b>NAVI SHORTCUT</b>	<b>6</b>	Gesture Control	
Changing the default Navigation App		Gesture Commands in Operation	
<b>Phone Caller Applet</b>	<b>6</b>	<b>VOICE COMMAND</b>	<b>14</b>
Adding Contacts and Navigation		<b>Floating Home and Media Button</b>	<b>14</b>
Various Calling Methods		Operation and Movement	
Deleting Contacts		Disabling the Feature	
<b>App Launcher</b>	<b>7</b>	<b>Audio Switching</b>	<b>15</b>
Adding Apps and Navigation		<b>SMS READER</b>	<b>15</b>
Changing App Launcher Layout		Enable SMS Reader	
Returning to JVC Smart Music Control		Enable SMS Blacklist	



## OTHER PREFERENCE SETTING 16

Preference Setting



## GETTING STARTED

JVC Smart Music Control App requires the following for proper operation:

- Android OS 4.0 and above
- Bluetooth support.

The system requirement information as mentioned above is not a guarantee that the application will work on all Bluetooth® compatible devices.

### Installing Smart Music Control App

JVC Smart Music Control is a free application, available in the Google Play Store. This app enhances the user experience of compatible JVC car receivers. Search for “JVC Smart Music” in Google Play Store to locate and download the Smart Music Control App into your device. Alternatively, you can scan the QR code using your android device below to directly access the Smart Music Control App in the Google Play Store.



### Preparing the Music Player

Copy music files into the internal storage or the SD card of your device.

#### Note

If music files are stored in the SD card, do not remove or dismount the SD card while playing songs.

#### Supported audio files\*

- MP3 (.mp3)
- AAC-LC/TLP (.m4a, .aac)
- PCM/WAVE (.wav)
- Ogg Vorbis (.ogg)
- AMR-NB (.3gp)
- AMR-WB (.3gp)

*\*Depends on your smartphone*

## MEDIA PLAYER

Media Player Mode playback songs saved in the device.

### Media Player Screen

1. Tap once on the Media Player screen to play the song.

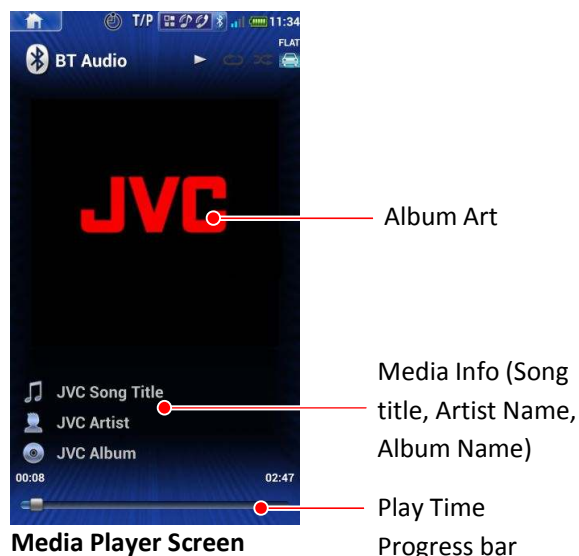

2. You can control the song playback as follows:
  - To pause or resume playback, tap once on the screen.
  - To skip to the previous song, swipe left.
  - To skip to the next song, swipe right.
  - To repeat all songs or one song, curve right.
  - To play songs at random, curve left.

(Refer to page 13 for Gesture Controls)

### Category Selection Screens

Songs in your device are automatically sorted into different categories for easy song selection. This list of screens displays the songs in their respective categories.

1. Go to “Menu > Content List” or Swipe up to open the Category Selection screen.



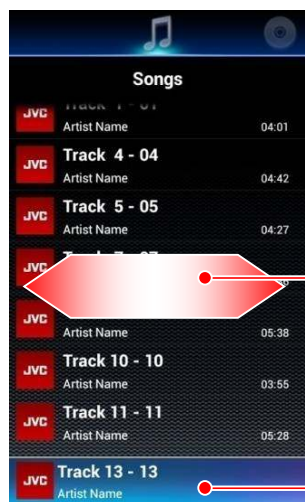

**List Screen**

Flick left or right to go to a different category screen.

**Currently playing song**  
Touch to change to Media Player screen

The available categories are: Songs, Albums, Artists, Playlist and Mood.

2. Swipe Left/Right to change categories, and tap on an item to select it. The item hierarchies are listed below:



>Songs



>Album > Song



> Artist >Albums > Song



> Playlists\*1 > Song



>Moods\*2 > Mood in detail > Song

*\*1 To play a song in Playlists, create playlist and add your favorite songs. -> See PLAYLIST (page 3)*

*\*2 To play a song in Moods, Mood Analysis must be performed in advance. -> See MOOD PLAYLIST (page 4).*

To return to the Media Player Screen, tap the currently playing song or tap the return key on your device.

## Current List Screen

Based on the category used to select the currently playing song, the lineup of all the songs in that chosen category is displayed in the Current List Screen.

1. Swipe down the Media Player screen to open Current List screen.



**Current List Screen**

Currently playing song

2. Tap a song to play.

To return to the Media Player screen, tap return key on your device.

## Mood Blender Screen

The Mood Blender Screen is a special display screen that displays an active visualization during song playback, and the pre-analyzed songs can be selected by using the Mood Selector.

1. Perform a 2-finger swipe left/right on the Media Player Screen to open the Mood Blender screen.

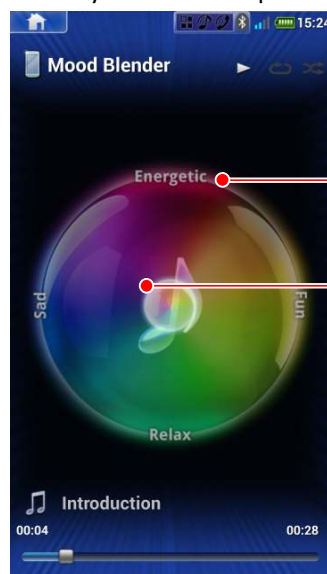

Mood Matrix Area

**Mood Selector**  
Move it to adjust the current mood

**Mood Blender Screen**



2. Tap and drag the Mood selector circle to your preferred mood in mood matrix area to adjust the current mood.

#### Note

To use the Mood Blender function, you first need to analyze all songs using the Song Background analysis function. (Page 4)

To return to the Media Player screen, perform a 2-finger swipe left/right on the Mood Blender screen.

## Making a Playlist

Playlists enables a custom selection of songs for continuous playback based on the individual preference.

1. In the Category Selection Screen, swipe to the Playlist category.
2. Select "Add New Playlist"
3. Enter a new name for this playlist and select OK.

## Adding Songs to a Playlist

Songs can be added to the playlist in "Current List Screen" and "Category Selection Screen > Songs".

1. While in any of the 2 screens, long press on a song item.
2. An "Add to Playlist" dialog screen will pop up. Select the appropriate playlist to add the selected song to.

## Equalizer Screen

### Select Preset Equalizer

1. Tap the Menu on your device.
2. Tap [  Equalizer ] in menu list.
3. Select Preset Equalizer Flat/Dynamic/Natural/Vocal Boost/Bass Boost.

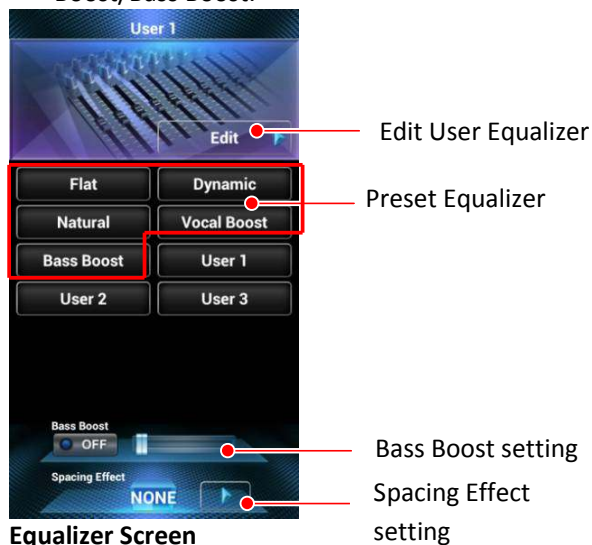

#### Note

Equalizer settings only apply to Media Player on your device. When the App is connected to a JVC Car Receiver and enters Remote Control Mode (See below), this Equalizer function will be disabled, and only the Car receiver's EQ settings will be available.

### Edit User Equalizer

1. Tap **User 1/ User 2/ User 3**.
2. Tap **Edit**.
3. Change the level of each band.
4. Tap **Save**.

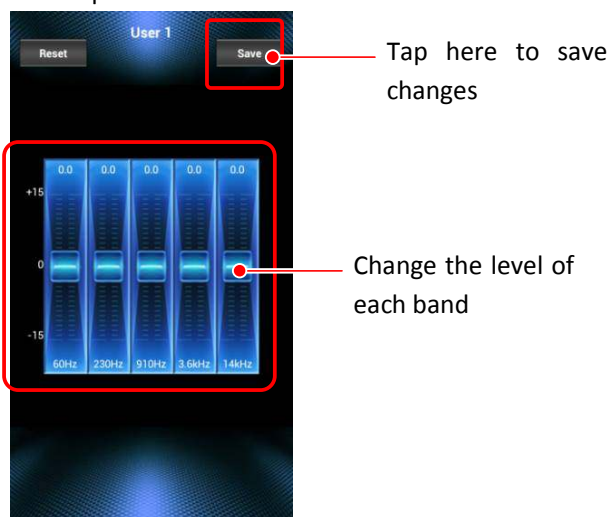

### User Equalizer Screen

To return to the Media Player Screen, tap the return key on your device.

### Bass Boost setting

1. Tap **Bass Boost** to ON.
2. Move the slide bar to adjust the Bass Boost level.

### Spacing Effect setting

1. Tap **Spacing Effect**.
2. Choose your preferred effect from the pop up list.



## Mood Playlist

JVC Smart Music Control analyzes the mood of songs using its Mood Analyzer Function. Once analysis is complete, songs are classified into the following 13 moods. The songs classified are added in [Moods] automatically and you can enjoy songs by selecting the individual mood.

Mood	Description
Acoustic: Gentle music comprising relatively weak tones	
Detailed	Piano solo, quiet classical music, etc.
Simple	Folk music, music playing with a few instruments
Smooth	Mature jazz
Easy	Slow ballad
Standard: Music with a feeling of rhythm	
Dynamic	Big-beat jazz playing by a big band
Rockin	Classic Rock
Vivid	Rock or Pop music with a good beat
Stylistic: Techno-pop or music playing with electronic instruments	
Cool	Ambient Techno
Urban	Dance, Bossa nova
Trance	Trance, Drum'n'Bass
High: Energetic and Loud	
Active	Rap, Hip-hop
Powerful	Hard Rock
Core	Punk, Metal
Unclassifiable	Song that cannot be classified or analyzed

### Note

The song cannot be analyzed if its time is shorter than 20 seconds.

## Song Background Analysis

### Analyze all songs

1. Tap the Menu button on your device.
2. Tap [Preference].
3. Check [Manual Song Mood Analysis].

All songs are analyzed while songs are playing. After analysis is completed, the songs will be classified and added in [Moods] automatically.

The current progress of Song Mood Analysis can be found in the Android Notification Panel in the Android Home Screen.

### Note

If the remaining battery capacity of your device falls below 20%, the background analysis will be stopped, in order to conserve battery.

### To cancel song analysis while analyzing all songs

1. Exit the application by pressing HOME on the device.
2. Pull down the Android Notification Panel.
3. Tap [ ] to display the song analysis status.
4. Tap [Analyzing ...(song name)].
5. Tap the Menu button on your device.
6. Tap [Cancel analysis] and then [OK].

## Play a song from Mood Category Screen

1. In the Category Selection Screen, swipe left/right to [moods category].
2. Tap Mood > Mood in detail > Song.

## HOME LAUNCHER

JVC Smart Music Control's Launcher interface has been designed for easy one-touch operation while driving a vehicle. You can now use JVC Smart Music Control as a preferred operation interface while driving.

The Home Launcher is the main screen where you can access the main features of JVC Smart Music Control.

### Accessing the Home Launcher

The Home Launcher can be accessed at any time by tapping on the HOME icon in the top left corner of the app.



HOME Icon

## The Home Launcher Screen



The Home Launcher screen enables you to select the following touch-friendly features of this app:



1. Navi – Launch the Navigation App of your choice.
2. Phone – Enters the Phone calling feature of this app.
3. App – Enters the App Launcher. Allows you to launch 3<sup>rd</sup> party apps from within JVC Smart Music Control.
4. Media – Launches/Returns you to the media player.
5. Source<sup>\*1</sup> – Launches the Source Control (Remote Control Mode), letting you control and view selected JVC Car Receivers display information wirelessly.

#### Note

<sup>\*1</sup> Source Control is only available when JVC Smart Music Control is connected to the Car Receiver. It replaces the “Media” Button when a connection is established.

The Home Launcher screen has 4 different layouts, each displaying different types of information.

Swipe left or right on the screen to switch between layouts.

#### Layout A



The First layout has a “ticker tape”-style information bar in the middle of the screen, which scrolls various types of information at different scenarios:

1. When App is not connected to any car receiver – “Title/Album/Artist”
2. When App is connected, and Car Receiver is in the following source:
  - a. USB or CD – “(USB/CD) Title/Album/Artist”
  - b. Tuner – “(Tuner) Station Name”
  - c. AUX/BT/Others – “(AUX/BT/Others)”

#### Layout B



The second Layout adds a digital clock, date and a battery indicator to its display, on top of the information bar as seen in layout A.

#### Layout C



The third Layout adds the display of current song's album artwork<sup>\*1</sup>, on top of the information bar as seen in layout A.

#### Layout D



The final Layout adds the display of GPS speed<sup>\*2</sup>, Wifi/Mobile signal strength<sup>\*3</sup>, battery bar and a digital clock, on top of the information bar as seen in layout A.



## Note

\*1 Album artwork will only be shown if the artwork is available in the source media.

\*2 GPS Speed will only be shown if GPS chip is present in the device, and it is enabled in Android Settings. GPS speed indicator in the UI is set to a min-max range of 0-240Km/h.

\*3 Wifi and Mobile Signal Strength will only be shown if it is present in the device, and it is enabled in Android Settings.

## NAVI SHORTCUT

The first feature accessible from the Home Launcher is the Navi Shortcut.

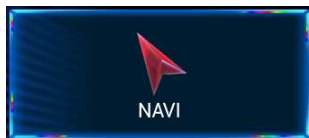

You can now access your favourite navigation app from the Home Launcher. Simply tap on the NAVI button, and the navigation app will launch.

## Changing the default Navigation App

You can change the default Navigation app in the Preferences menu.

1. Tap the MENU button on your device.
2. Tap [Preference].
3. Tap [Launcher Settings].
4. Tap [Set Default Navi App].
5. Select your preferred Navigation App and save.

## PHONE CALLER APPLET

The Phone Caller Applet feature is a touch-friendly interface that allows you to make mobile or VOIP calls to selected contacts through large and accessible icons.

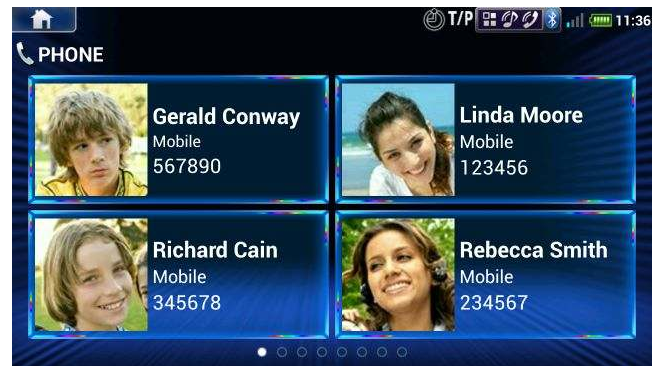

## Adding Contacts and Navigation

To add a contact to the applet, tap on the "+" icon in an empty box. A selection screen will allow you to scroll through your contacts. Select a contact and tap "ADD".

The Phone Caller Applet is able to save up to 32 (8 pages of 4 contacts each) of your favourite contacts for quick access. Simply swipe left and right to navigate between the pages.

## Various Calling Methods

Once the contact is saved in a box, tap on the contact to bring up the contact's detail screen:



This screen shows the available calling methods that you can make to the contact. To add more calling methods or to edit contacts, tap on the settings icon  in the top right corner of the dialog box.





Here you can edit contact names, numbers, and also add VoIP calling by ticking the appropriate checkbox and entering the contact's details for that VoIP program.

Once done, press SAVE to save all edited information.

To make a call via mobile/VoIP to the contact, simply tap in the appropriate call icon in the contact details screen.



## Deleting Contacts

To delete a contact from a box, tap the MENU button on your device, and select "EDIT" to enter the edit mode.

An "X" will appear at the right side of every box. Tap on the "X" to delete that contact.

Tap the BACK button on your device to exit the edit mode.

## APP LAUNCHER

The App Launcher feature allows you to access any 3<sup>rd</sup> party app using a touch-friendly interface that supports multiple layout patterns.



## Adding Apps and Navigation

To add an App to the launcher, tap on the "+" icon in an empty box. A selection screen will allow you to scroll through your apps. Select a contact and tap "ADD".

The App launcher is able to save up to 24 of your favourite apps for quick access. Simply swipe left and right to navigate between the pages.

## Changing App Launcher Layout

The App Launcher has included a total of 9 different layout designs, with varying sizes of app boxes, for you to choose.

Tap on the settings icon  in the top right corner of the screen, and select between the 9 possible layouts.

## Returning to JVC Smart Music Control

In order for easy access to JVC Smart Music Control interface while operating 3<sup>rd</sup> party apps, a feature called the Floating Home and Media Button has been implemented. The Floating Home and Media Button will always remain on top of any 3<sup>rd</sup> party app that is launched from within JVC Smart Music Control.

For more information on the Floating Home and Media Button, please refer to the section in this Guide, entitled "Floating Home and Media Button".

## MEDIA PLAYER SHORTCUT

The Media Player Shortcut will bring you back to the Media Player screen.



For more information on Media Player operation, please refer to the section in this Guide, entitled “Media Player”.

## JSMC REMOTE CONTROL MODE

JVC Smart Music Control is able to connect to a JVC Receiver, and functions like sending remote control commands, receiving data and other useful information from the receiver can be performed.

### Entering into Remote Control Mode

In order to access the Remote Control Mode function, the android device must first be paired with a compatible BT-enabled JVC Car Receiver present within 10m of the Android device. (Visit the JVC website [Link Here](#) for device compatibility.)

1. Perform a Bluetooth pairing between the Android device and the JVC Car Receiver.
2. Once pairing is successful, launch JVC Smart Music Control App on the Android device.
3. Go to “Menu > Connect” to initiate a connection between the app and the receiver.
4. Select the JVC receiver that was paired earlier in the dialog box that pops up.
5. Wait for further instructions to appear on the app screen.
6. The app is now connected to the receiver, and the app enters Remote Control Mode.

## SOURCE CONTROL MAIN SCREEN

The Source Control is the main operating interface in Remote Control Mode.

In this interface, you will be able to retrieve and view detailed information from the current source being played in the car receiver, as well as performing basic remote control functions from your device to the car receiver.

The Source Control interface will launch automatically every time JVC Smart Music Control establishes a connection with a JVC car receiver. The Source Control

interface is also available in the Home Launcher Screen, when connected to a car receiver.

The following sections provide a detailed description of items displayed while using Smart Music Control App in Remote Control Mode.

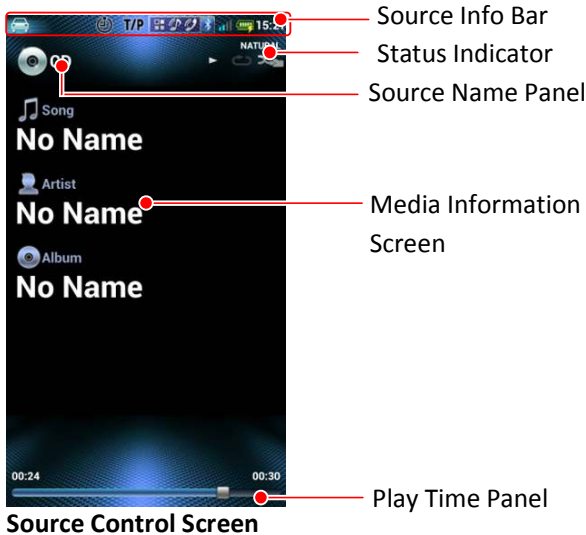

### Status Indicator

The status area shows the connectivity status for various Bluetooth functions, and status of traffic program, radio timer in car receiver.

Functions	On	Off
Bluetooth		
Bluetooth Hands-free connection		
Bluetooth Audio connection (A2DP*)		
JVC Applink connection		
T/P (Traffic Program)		
Radio Timer		

\* Advanced Audio Distribution Profile (A2DP)

### Source Name Screen

The source name panel shows the currently selected source in the connected JVC car receiver.



The following table is the list of the source.

Icon	Source
	USB
	SD
	iPod Mode
	iPod Head Mode
	iPod App Mode
	CD
	Tuner
	HD Radio *1
	Bluetooth Audio
	Aux-In
	Android
	Unknown *2





\*1 Available for HD Radio Ready car receiver models only

\*2 Smart Music Control App does not support Satellite Radio, EXT IN and BT Pandora.



## Source Info Bar

The source info bar shows the playback status.

### Repeat Indicator

Icon	Repeat Type
	Repeat Off
	Repeat Once
	Repeat Folder/ Group
	Repeat All

### Random Indicator

Icon	Random Type
	Random Off
	Random Folder/Group
	Random All

### Play/Pause Indicator



Play/Pause indicator shows the current playback status.

### Mute Indicator



Mute indicator shows the volume status of the receiver (Mute On/Off).

Mute indicator is available for sources which do not support play/pause operations, except Bluetooth Audio source.

### Stereo/Mono Indicator

Stereo/Mono icon is available only in Tuner source. If Stereo/Mono icon does not appear, the current station does not have available Stereo/Mono information.

### HD Radio Indicator

HD Radio indicator shows availability of HD radio in the current frequency. "HD" flashes when the car receiver is searching for a HD channel. "HD" lights up when the car receiver finds a HD channel. "HD" goes off when the car receiver is unable to find any HD channel in the current frequency.

### EQ Indicator

The EQ icon shows the selected EQ setting of the current source in the car receiver. Refer to the JVC car receiver user manual for more details on supported EQ.

## Media Information Panel

The media information panel displays some information of a song or a radio station. For example, when the car receiver plays MP3 song with ID3 tag, the song title, artist name and album name are displayed.

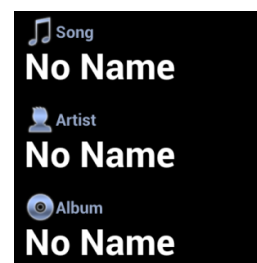

When playing a song

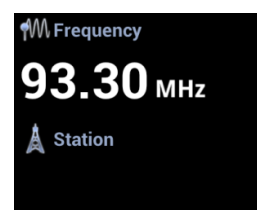

When listening to the radio



## Play Time Bar



Play Time Bar is only available for sources that support play time indication, which include sources like CD-DA and Music Files in USB mass storage.

## CAR RECEIVER SETTINGS

JVC Smart Music Control allows you to adjust certain car receiver settings<sup>\*1</sup> directly from your device. This is done in Remote Control Mode, through the Source Control interface.

### Entering Car Receiver Settings

In Source Control interface, tap the MENU button on your device, and select “Receiver Settings”.

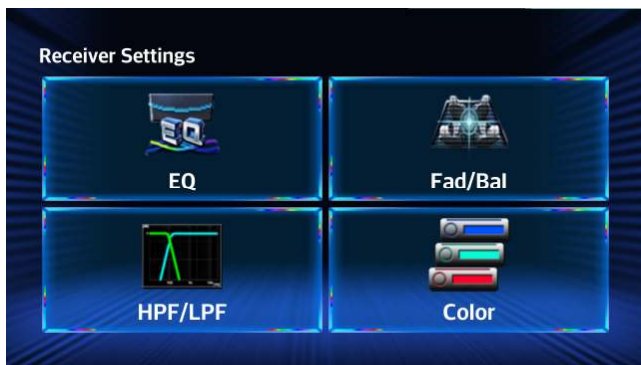

You will be presented with the receiver setting parameters that are available for your Car receiver model.

#### Note

<sup>\*1</sup> EQ and Fader/Balance settings are only available for certain Y2014 and 2015 Car Receiver models. HPF/LPF and Color settings are only available for certain Y2015 Car Receiver models.

## EQ Settings



In EQ Settings, tap on any Preset EQ button to change the Car Receiver’s EQ immediately.

For User EQ, first select a User EQ, and then tap on the EDIT button to edit the User EQ Setting.



Tap here to edit User EQ.

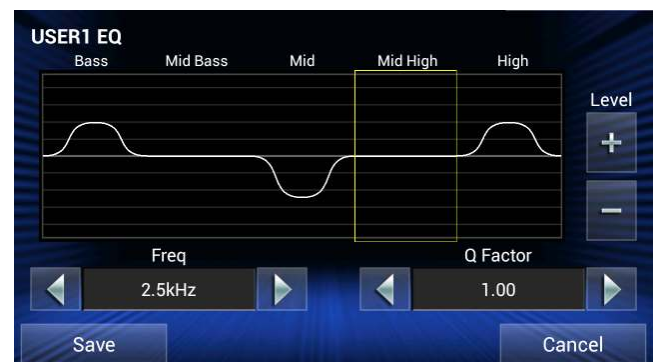

You will be presented with the User EQ Edit Screen. Tap on the respective zones to edit that range.

Press SAVE to send changes to the Receiver.



## Fader/Balance Settings



In Fader/Balance Settings, tap on any of the arrows to move the crosshair to the approximate position as indicated in the simulated cabin graphics. You can also tap directly on the simulated cabin graphics to position the crosshair. Press SAVE to save the settings to the car receiver.

## HPF/LPF Settings

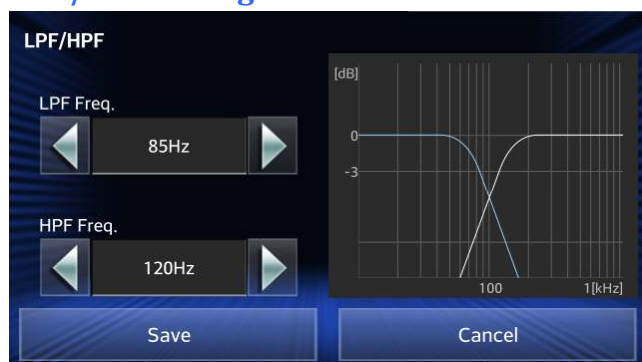

In HPF/LPF settings, tap on the respective arrows to adjust High Pass Filter and Low Pass Filter. Press SAVE to save the settings to the car receiver.

## Color Settings



In Color Settings, there are 2 submenu options: Preset Color and User Color. Both submenu options will change the respective color in JVC receiver in all zones. (Individual zone color changes are only available on the receiver itself.)

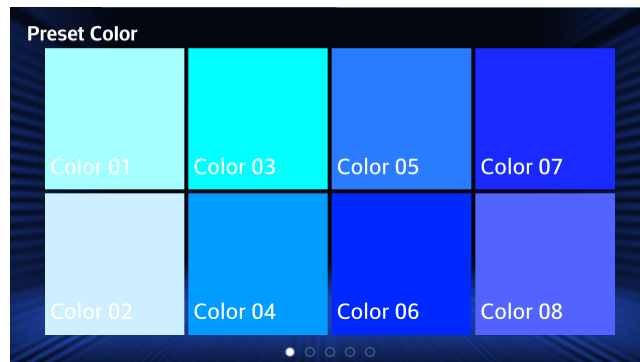

Tap the Preset Color tab to enter preset color settings. Swipe right or left on the screen to select more preset color options.

Tap directly on the color square to send and save the color to the JVC receiver simultaneously. Press BACK on the device to exit this screen.

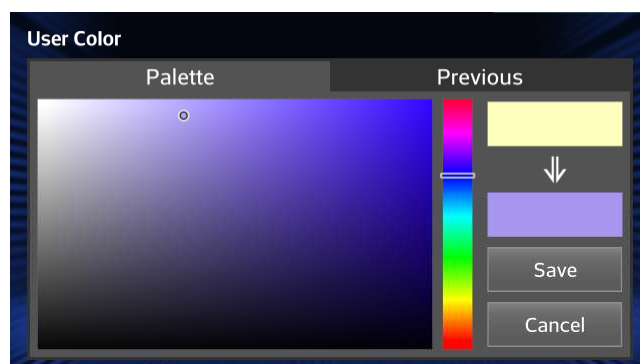

2 tabs are available in this screen.

Under the Palette tab:

Tap on the User Color tab to enter User Color setting. In this screen, a color palette is available for the user to choose from all available colors.

Drag the slide bar to select the base color, and tap on the color sheet to select the color shade of the base color. The JVC receiver will automatically display the selected color as the user taps on the screen, but the color will not be saved on the receiver until the user selects the SAVE button on the right.



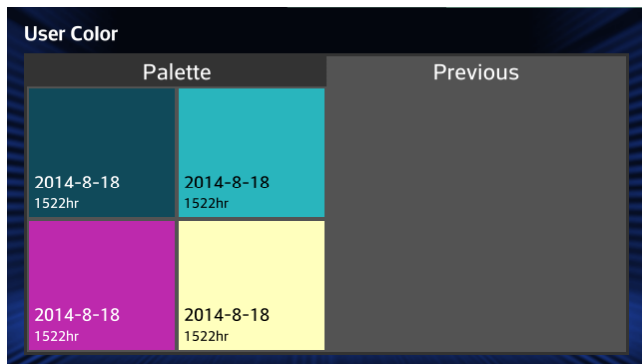

Under the Previous tab:

The last 8 previously saved user colors (when saved using JSMC) are available in this screen, and tagged by date and time automatically. Tap on the color square to retrieve a previously saved color.



## OPERATION FEATURES

### Gesture Control

Gesture control operation is designed for quick operation control without looking at the smart phone.

Refer to JVC Smart Music Control App internal help ("menu->preference->help") for more details.

All gesture control patterns in JVC Smart Music Control App are showed in the figure below.

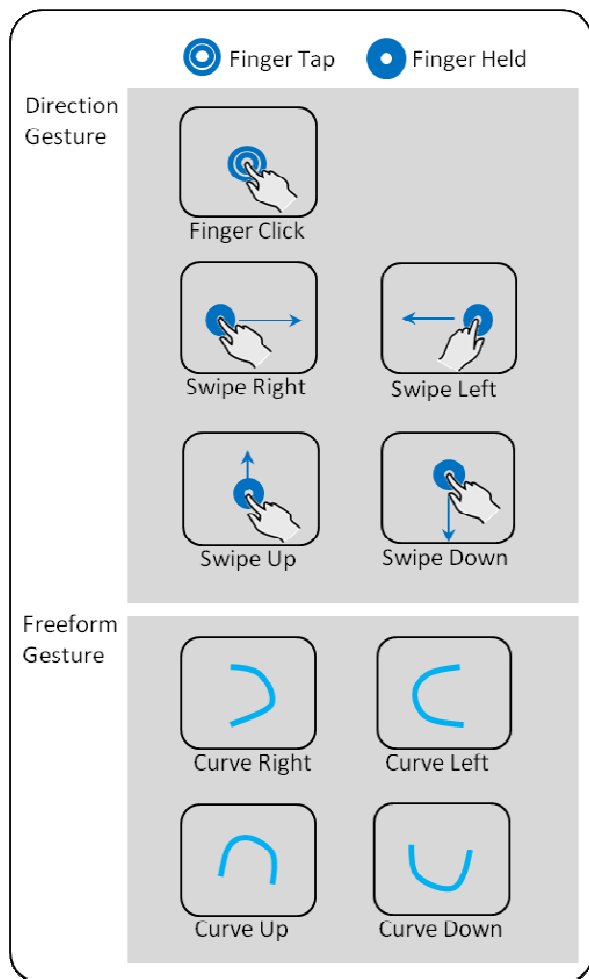

#### Note

For freeform gestures, these gestures can be initiated from any direction as long as the final drawn shape is similar to the gestures in the chart.

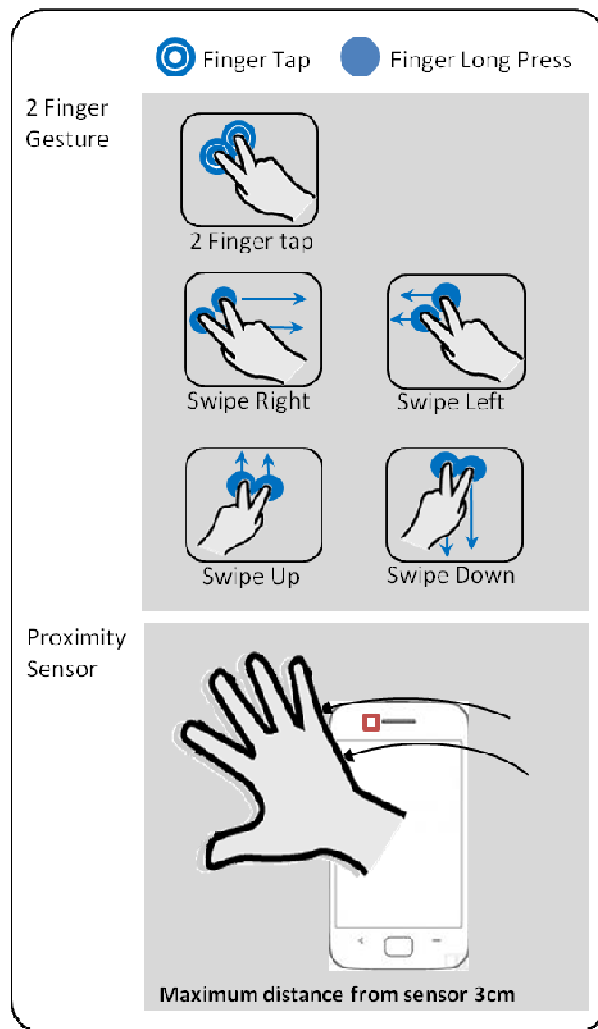

#### Note

To enable proximity sensor, turn on the proximity sensor in the preference setting.

### Gesture Commands in Operation

The same gesture controls performed in different sources will trigger different operations. The mapping of each gesture control to each source is listed in the table below.

Gesture	Remote Control Mode*	Media Player Mode
<b>Direction Gesture</b>		
<b>Finger Click</b>	Play/Pause/ Mute	Play/Pause
<b>Long Click</b>	Voice command	Voice command
<b>Swipe Right</b>	Next Song/Right Auto Scan	Next Track
<b>Swipe Left</b>	Previous Song/Left Auto Scan	Previous Track
<b>Swipe Up</b>	Folder Up/Group Up/Up Preset	Load Content List UI
<b>Swipe Down</b>	Folder Down/Group Down/Down Preset	Load Current Playlist UI



Freeform Gesture			
	Curve Right	Random Toggle/HD UI*2	Random Toggle
	Curve Left	Repeat Toggle/HD UI*2	Repeat Toggle
	Curve Up	Source Change	None
	Curve Down	EQ Toggle	Toggle Preset EQ
Multi Point Gesture			
	2 Finger Swipe Up	Volume UP	None
	2 Finger Swipe Down	Volume Down	None
	2 Finger Swipe Left	Load Mood Selection	Load Mood Selection*1
	2 Finger Swipe Right	Load Mood Selection	Load Mood Selection*1
Other Sensor			
	Proximity sensor	Voice Command	Voice Command

#### Note

\*1 In Bluetooth Audio source, control functions depend on phone.

\*2 HD AM/FM supports display of TEXT information of current streamed music.

## VOICE COMMAND

JVC Smart Music Control App accepts voice command to control playback and music search. Besides the playback control, voice command can also control other actions while in Car Receiver mode (e.g. change source, tune preset).

Before you start voice command, choose your preferred voice recognition engine language in “Voice music search language” located in the preference setting.

To trigger voice command, perform a 2 finger tap or the proximity sensor gesture. Wait for “ready tone” before speaking your command.

Voice Command	Car Receiver Mode	Media Player Mode
Playback Control Command		
Next	⊙	○
Previous	⊙	○
Repeat off	⊙	○
Repeat all	⊙	○
Repeat track	⊙	○
Repeat group	⊙	X
Random off	⊙	○
Random all	⊙	○
Random group	⊙	○

Music Search Command		
Search song	○*BT Only	○
Search artist	○*BT Only	○
Search album	○*BT Only	○
Car Receiver Mode Command		
CD	○	X
SD	○	X
USB	○	X
Bluetooth	○	X
Auxiliary	○	X
iPod	○	X
iPhone	○	X
FM	○	X
Am	○	X
HD Radio	X	X
Android	X	X
Preset 1	○*Tuner Only	X
Preset 2	○*Tuner Only	X
Preset 3	○*Tuner Only	X
Preset 4	○*Tuner Only	X
Preset 5	○*Tuner Only	X
Preset 6	○*Tuner Only	X

X Not Support, ○ Full Support, ⊙ Partial Support

#### Note

The Voice recognition engine requires internet access to process voice data.

## FLOATING HOME AND MEDIA BUTTON

The Floating Home and Media Button is a feature that allows quick access back into JVC Smart Music Control, whenever another 3<sup>rd</sup> party app is running in the foreground. This feature consists of a movable button in the top layer of the screen, that always stays on top of any 3<sup>rd</sup> party application.



#### The Floating Home and Media Button

Tapping on the Home button (on the left) will bring the user back to the JSMC Home Launcher. Tapping on the Media button (on the right) will bring the user back to the JSMC Source Control Main Screen.



The Floating Home and Media Button will appear in the top left corner of the screen, whenever user goes to another 3<sup>rd</sup> party program, either through the App Launcher interface, or by the default Android buttons.

Once user is back in JVC Smart Music Control, the Floating Home and Media Button will automatically disappear.

## Operation and Movement

1. Simply tap on the Floating Home Button to return to JVC Smart Music Control's Home Launcher.
2. Simply tap on the Floating Media Button to return to JVC Smart Music Control's Source Control Main Screen.
3. If you want to move the button, simply drag the button to another desired location.

## Disabling the Feature

Either buttons can be independently disabled. Should you wish to disable this feature, or individual buttons, you can do so in the Preferences Setting.

1. Tap the MENU button on your device.
2. Tap [ Preference].
3. Tap [Application Settings].
4. Uncheck [Floating Home Icon] to remove the Home button.
5. Uncheck [Floating Media Icon] to remove the Media button.

## AUDIO SWITCHING

Audio Switching is a special feature that allows 3<sup>rd</sup> party apps to signal the supported car receiver<sup>\*1</sup> to temporarily allow audio segments<sup>\*2</sup> to be played on the car speakers, for the user to hear.

This feature works as follows:

1. JVC Smart Music Control is firstly in Remote Control mode, and user launches a 3<sup>rd</sup> party app.
2. An audio segment<sup>\*2</sup> is played from the 3<sup>rd</sup> party app. JVC Smart Music Control sees the incoming audio segment.
3. JVC Smart Music Control sends an interrupt command to Car receiver.
4. Car Receiver will switch audio to allow the audio segment to be played over BT Audio<sup>\*3</sup>, and after the audio segment ends, car receiver will

automatically switch back to the previous source and continue playback.

This feature is useful for listening to important audio segments like Navigation audio prompts, or any notification prompts that make use of the Android interrupt command set.

### Note

<sup>\*1</sup> Audio Switching feature is only available for certain Y2014 and newer Car Receiver models.

<sup>\*2</sup> Applies to audio interrupts that uses Android *SHORT* and *LONG DUCK* audio interrupts only.

<sup>\*3</sup> A special interrupt text will be displayed on the Car Receiver to inform the user of the Audio Switching.

## SMS READER

The SMS reader function in JVC Smart Music Control App reads out incoming SMS messages. It makes use of the Android Text-to-Speech engine to read out the SMS message.

### Enable SMS Reader

1. Tap the Menu button on your device.
2. Tap [ Preference].
3. Tap [SMS Reader].  
Option list appears.
4. Choose your reference option.

### Note

In order to read out SMS messages, the Android Text-to-Speech engine first requires a download of voice data information in your preferred language.

### Enable SMS Blacklist

4. Tap the Menu button on your device.
5. Tap [ Preference].
6. Check [Enable SMS Blacklist].
7. Tap [SMS Read Blacklist].  
SMS blacklist screen appears.



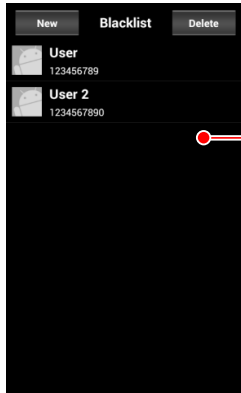

Blacklisted contact

**SMS Blacklist screen**

8. Add contact into blacklist.

## OTHER PREFERENCE SETTING

### Preference Setting

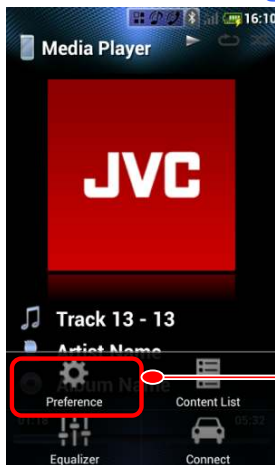

Preference setting

**Menu Screen**

Other preference settings can be accessed by pressing the MENU key on the device. Descriptions for various options are provided in the preferences setting screen itself.

### Software MENU Key

Some devices do not have a hardware MENU key, and do not make use of the virtual buttons. In this case, the MENU operation is performed means of a software MENU button located on the right side of the HOME button (top left corner).



Software MENU Button

1. Long press on the HOME button, and wait till the MENU button slides down beside the HOME button.
2. Slide your finger to the right, on to the MENU button.
3. Release finger, and Preferences menu will appear at the bottom of the screen.